

## Mounting without Bracket

**Step 1:** Remove ½" fixture knockout.

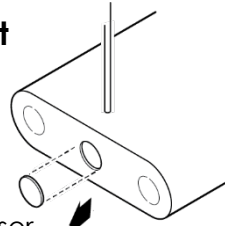

**Step 2:** Slide to open the Sensor Carrier back cover.

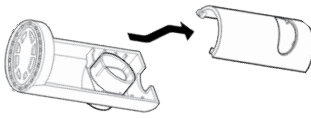

**Step 3:** Using your thumb or pliers, push and remove the knockout of the front carrier.

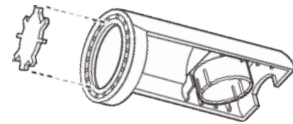

**Step 4:** Insert the ½" Chase Nipple through the knockout hole in the carrier.

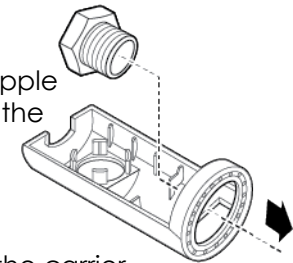

**Step 5:** Insert the sensor into the carrier by pulling the cable through the Chase Nipple. Make sure the sensor lens clicks and is visible through the hole in the front.

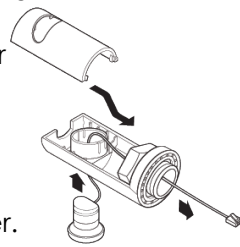

**Step 6:** Slide to close the back cover.

**Step 7:** Mount the carrier to the fixture by tightening the Chase Nipple with the locknut.

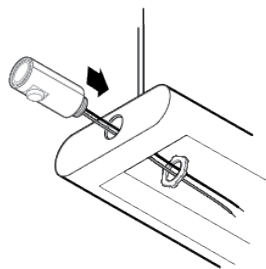

## Wiring the Cables to the Control Unit or Driver

**Step 1:** Wire the other end of the sensor cable to the Control Unit, driver, or power supply.

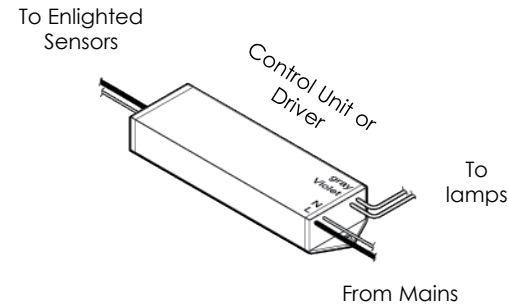

Copyright © 2023 Enlighted Inc. All rights reserved.  
All other brand or product names are trademarks of their respective companies or organizations.

### Technical Support

For questions regarding the installation or operation of this product, contact Enlighted

**Technical Support:** [support@enlightedinc.com](mailto:support@enlightedinc.com)

### Company Contact Information

**Location:** : 3979 Freedom Circle, #210,

Santa Clara, CA 95054

**Phone:** +1.650.964.1094

**Web:** [enlightedinc.com](http://enlightedinc.com)

**Model:** CASE-SU-5E



## SU-5E Mounting Case Installation Guide



SU-5E Mounting Case

### Shipped Components

- SU-5E Sensor Carrier
- SU-5E Mounting Bracket
- ½ inch Chase Nipple and Locknut
- 2 nos. #8 Anchor Screws (Drywall® mount)
- 2 nos. #8 Metal Self-tapping Screws (Fixture mount)

### Items you may Need

- 400BAC Wiremold® Conduit
- 18" AWG Cable
- 30 inch Sensor cable for CU-4 and IoT Ready™ drivers (CBL-5E-CU4-30N)
- 7 foot Sensor cable for CU-4 and IoT Ready™ drivers (CBL-5E-CU4-7F)

### Tools you may Need

- ½" knockout set
- Hand drill
- Wire stripper
- Pliers
- Phillips screwdriver

The SU-5E Mounting Case is designed for use with the SU-5E sensor.

### Caution

- Installation and maintenance must be performed by a qualified electrician in accordance with local, state, and national electrical codes (NEC) and requirements.
- Turn off power to the light fixture by switching off the circuit breaker.

### Mounting with Bracket

You can mount the Micro sensor to fixtures with knockout, or to sheetrock and fixtures without a knockout

#### Option 1: Fixtures with Knockout

**Step 1:** Connect the 8-pin end of the sensor cable to the sensor.

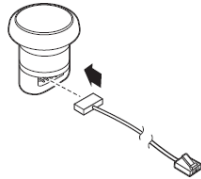

**Step 2:** Guide the sensor cable wire through the front and back holes in the sensor carrier. Pull the cable gently until the sensor lens clicks securely into the carrier.

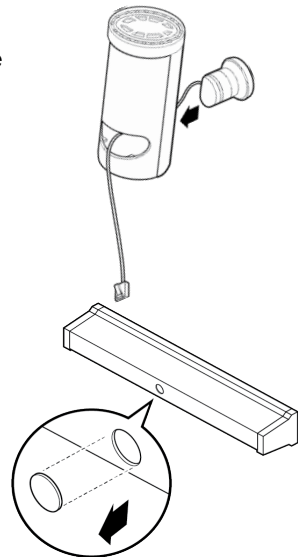

**Step 3:** Remove the 1/2" fixture knockout.

**Step 4:** Insert 1/2" Chase Nipple to the inside of the bracket.

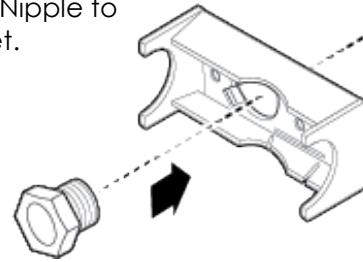

**Step 5:** Connect the bracket to the fixture by threading the locknut screw to the Chase Nipple.

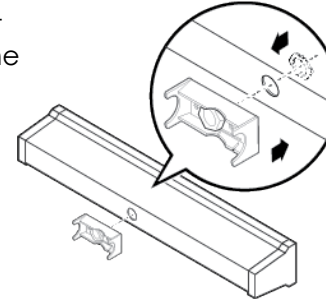

**Step 6:** Align the sensor lens with the curved edge of the bracket, insert the sensor cable through the Chase Nipple into the fixture.

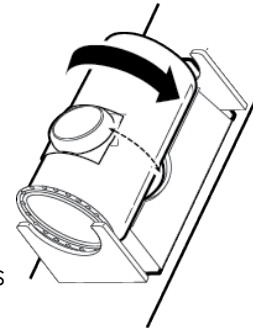

**Note:** Only when the sensor lens is aligned with the curved edge of the bracket, the sensor can rotate freely to the desired angle within the bracket.

**Step 7:** Insert the sensor cable through the Chase Nipple into the fixture.

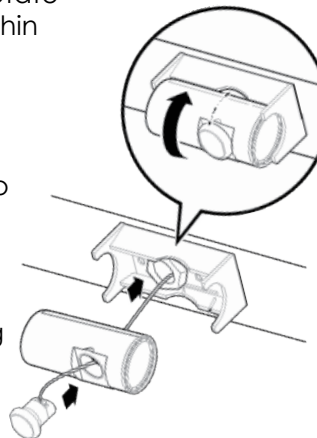

**Step 8:** Slide the sensor carrier until it clicks into the mounting bracket.

### Option 2: Sheetrock and Fixtures without Knockout

**Step 1:** Locate the tab on the side of the mounting bracket and break away the tab.

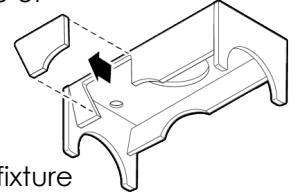

**Step 2:** Mount the bracket to the fixture or drywall.

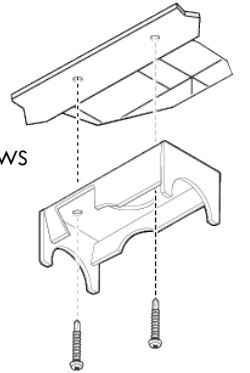

1. Fixtures: use metal-self tapping screws
2. Drywall: use anchor screws

**Step 3:** Insert the carrier with the sensor into the bracket. Make sure the sensor wires exit through the open slot in the bracket.

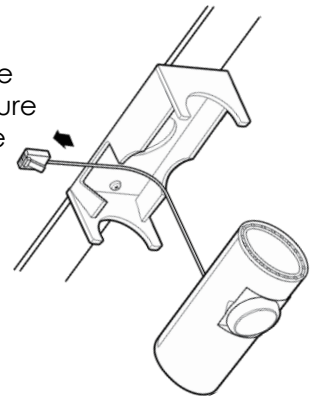

**Step 4: only for drywall** Insert the cable through the Wiremold conduit.

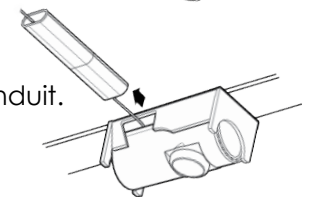

### Rotating the Sensor

After mounting with the bracket, rotate the sensor to the required direction.